

## WTS WIRELESS LOAD CELL COMMUNICATION SYSTEM

### FEATURES & BENEFITS

The WTS (Wireless Telemetry System) provides easy-to-use wireless data communication between a load sensor and a receiving indicator. The WTS-BS receiver is capable of receiving multiple inputs from various load cells or torque transducers.

The WTS-AM is fully compatible with all of Interface's force sensors, and comes direct from our factory setup, calibrated, and tested – ready-to-run.

Using AA batteries or D batteries, the WTS-AM system can last for many months\* without a battery change.

### SPECIFICATIONS

EXCITATION		
Excitation Voltage – VDC		5
PERFORMANCE		
Input Range – mV/V (max)		±4.5
Radio Type / Frequency – GHz		2.4; FCC conforming
Transmit Rate – /sec		3 typical
Available Channels		16
ENVIRONMENTAL		
Operating Temperature	°C	-40 to +65
	°F	-88.18 to +143.3
IP Rating		IP67

### OPTIONS

TRANSMITTERS	
WTS-AM-1E	mV/V input
WTS-AM-2	Voltage input 0-10
WTS-AM-3	Current input 0-20 or 4-20 mA
RECEIVERS	
WTS-BS-1	Hand-held display with multi-channel capability
WTS-BS-3E	USB base station receiver for use with PC for data logging and/or WTS module configuration with a 500 m (1,640 ft) range
WTS-BS-4	Ruggedized USB base station receiver for use with PC for data login and/or WTS module configuration. Provides extended range usage up to 800 m (2,625 ft)
WTS-BS-5	Industrial analog output module for voltage or mA output up to 800 m (2,625 ft)

**\*The WTS system functionally includes sleep and wake modes for external battery life.**

### STANDARD CONFIGURATION



WTS-BS-1 (Shown)



WTS-BS-3E (Shown)



WTS-BS-5 (Shown)



WTS-AM-1E-D (Shown)  
(2) "D" Size Batteries



WTS-AM-1E (Shown)  
(2) "AA" Size Batteries

### TRANSMITTER MODULE (WTS-AM)

- m/V, voltage, or current input with full 24-bit ADC and up to 18-bit effective resolution up to 200 updates/sec.
- 2.4 GHz frequency with up to 800 m (2,625 ft) range
- IP67 NEMA4 enclosure
- AA Battery Enclosure 80 x 62 mm (3.1 x 2.4 in) or D Battery Enclosure 164 x 84 mm (6.5 x 3.3 in)
- Factory set-up to work properly with your selected sensors
- Sleep mode

### HANDHELD BASE STATION (WTS-BS-1)

- 8-Digit display
- System Zero Function
- Up to 800 m (2,625 ft) range
- IP67 waterproof enclosure 90 x 150 x 35 mm (3.5 x 5.9 x 1.4 in)

## WTS WIRELESS LOAD CELL COMMUNICATION SYSTEM

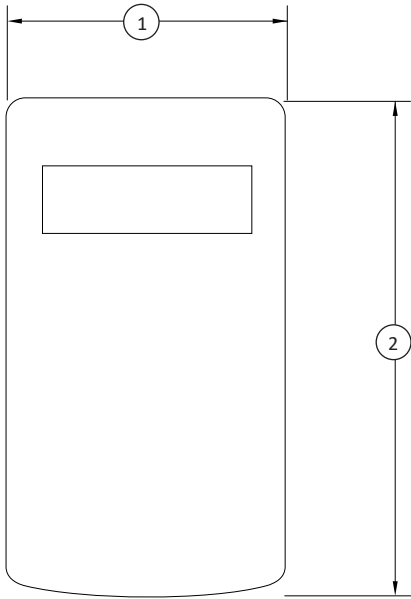

WTS-BS-1

### DIMENSIONS

See Drawing	Metric (mm)	U.S. (in)
(1)	90	3.54
(2)	152	5.98
Height	34	1.34

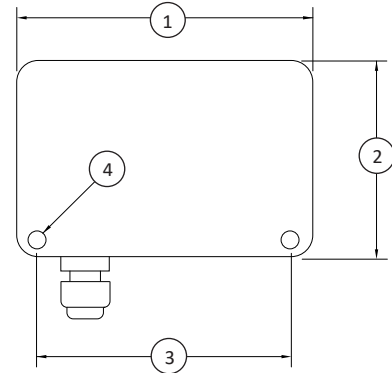

WTS-AM-1E (2) "AA" Size Batteries

### DIMENSIONS

See Drawing	Metric (mm)	U.S. (in)
(1)	80	3.15
(2)	62	2.44
(3)	66.5	2.62
(4)	Ø4.8	Ø0.19
Height	34	1.34

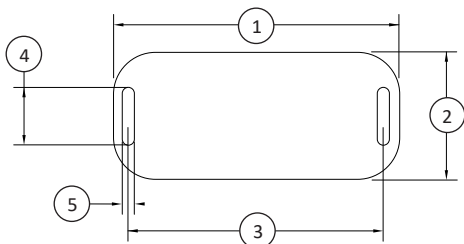

WTS-BS-3E

### DIMENSIONS

See Drawing	Metric (mm)	U.S. (in)
(1)	76	2.99
(2)	35	1.38
(3)	68	2.68
(4)	15	0.59
(5)	3.2	0.16
Height	20	0.79

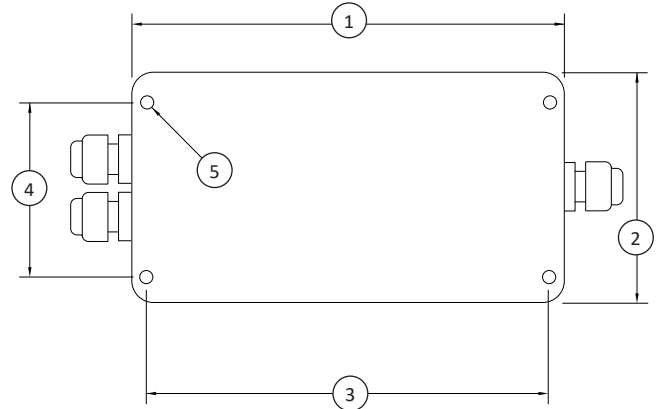

WTS-AM-1E-D (2) "D" Size Batteries

WTS-BS-5

### DIMENSIONS

See Drawing	Metric (mm)	U.S. (in)
(1)	164	6.46
(2)	84	3.31
(3)	148	5.83
(4)	50	1.97
(5)	Ø4.5	Ø0.18
Height	57	2.24