

Interface Inc. claims proprietary rights in the information disclosed hereon. This drawing is furnished in confidence on the express understanding that neither it nor any reproduction thereof will be disclosed to others or used for the purpose of manufacture or procurement of the article or part shown hereon without written permission of Interface Inc. The drawing shall remain the property of Interface Inc. and shall be returned upon request by Interface Inc.

81504

REVISIONS

REV.	DESCRIPTION	DATE	APPROVED
A	INITIAL RELEASE	08/12/15	DLC

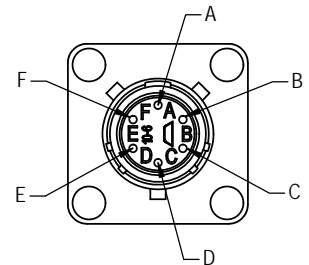
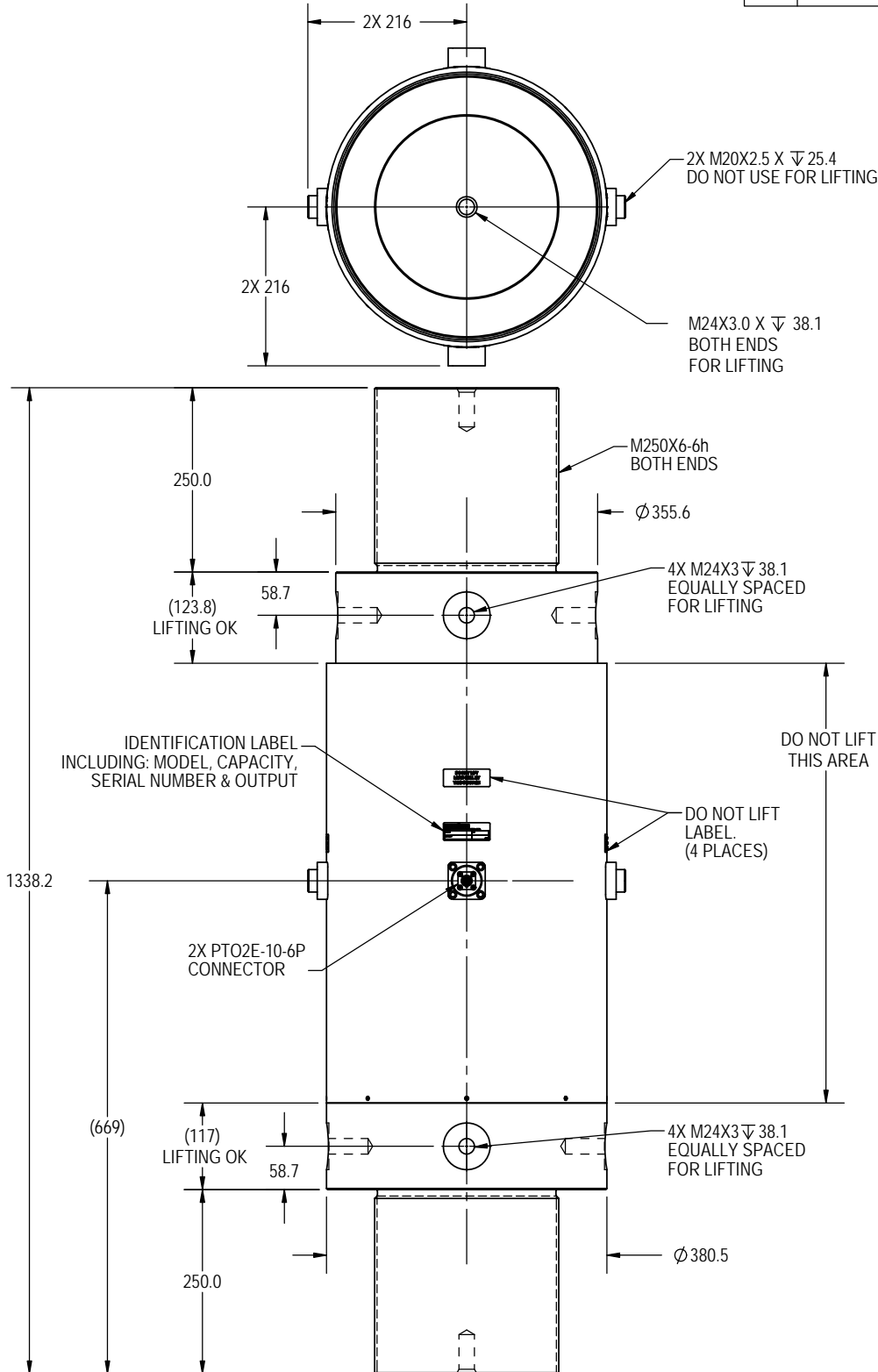

CONNECTOR PINOUT

PIN	FUNCTION
A	+ EXCITATION
B	+ SIGNAL
C	- SIGNAL
D	- EXCITATION
E	- SENSE
F	+ SENSE
TENSION UPSCALE	

4. LOAD CELL WEIGHT (APPROXIMATE): 740 kg
3. FLEXURE MATERIAL: STEEL
2. DIMENSIONAL TOLERANCE: ± 1.0
1. ALL DIMENSIONS ARE mm UNLESS OTHERWISE SPECIFIED.

ALL DIMENSIONS ARE FOR REFERENCE ONLY AND SUBJECT TO CHANGE. CONTACT ENGINEERING DEPARTMENT TO CONFIRM VALIDITY.

CREATOR	DATE
DESIGNED: ALBERT L.	08/07/15
DETAILED: DLC	08/07/15
OUTPUT:	
CAM DATA:	

interface
ADVANCED FORCE MEASUREMENT
7401 E. BUTHERUS DR. SCOTTSDALE, AZ USA 85260

TITLE:
OUTLINE, MODEL
2163FAQ-15MN

SIZE: A	DWG. NO: 81504	REV: A
SCALE: 1:9	SHEET 1 OF 1	

CAD FILE <N:\-81504A.SLD***>