

Model 5350 & 5355 Solid Flange Reaction Torque Cell

Why the Interface model 5350 & 5355 Reaction Torque Cell is the best in class:

- High Torsional Stiffness
- Extraneous Load Resistance
- Compact Size
- Optional ± 10 VDC output available on 100 oz-in and above



DIMENSIONS

| See Drawing | SOLID FLANGE TYPE | | | | | |
|-------------|--------------------------------------|---------------------------|---------------------------|------------------------------|-------------------------------|------------------|
| | 5350 | 5355 | | | | |
| | CAPACITY (oz-in) 10,20,50,100,200 | CAPACITY (lb-in) | | | | |
| | 10,20,50 | 100,200,500 | 1K,2K,5K | 10K,20K | 50K,100K | |
| ① | 1.50 inch | 2.00 inch | 2.75 inch | 4.50 inch | 6.00 inch | 8.00 inch |
| ② | 1.00 inch | 1.375 inch | 2.000 inch | 3.875 inch | 5.375 inch | 7.375 inch |
| ③ | 0.875 inch | 1.250 inch | 1.875 inch | 3.750 inch | 5.25 inch | 7.250 inch |
| ④ | 1.50 inch | 2.125 inch | 2.75 inch | 3.50 inch | 4.50 inch | 5.50 inch |
| ⑤ | 1.375 inch | 1.875 inch | 2.375 inch | 3.00 inch | 3.75 inch | 4.75 inch |
| ⑥ | .0625 inch | 0.125 inch | 0.188 inch | 0.25 inch | 0.375 inch | 0.375 inch |
| ⑦ | 0.563 inch | 0.750 inch | 1.250 inch | 2.750 inch | 4.000 inch | 5.750 inch |
| ⑧ | #4-40 UNC-2B 2 places | #10-32 UNF-2B 2 places | 1/4-20 UNC-2B 4 places | 3/8-24 UNF-2B 4 places | 7/16-20 UNF-2B 8 places | 5/8-18 UNF-2B |
| ⑨ | 0° | 0° | 0° | 0° | 22.5° | 15° |
| ⑩ | Conxall 7282-GPG-300 | CF3102E-14S-6P | CF3102E-14S-6P | CF3102E-14S-6P | CF3102E-14S-6P | CF3102E-14S-6P |

SPECIFICATIONS

ACCURACY – (MAX ERROR)

Nonlinearity—% FS ± 0.1
 Hysteresis—% FS ± 0.1
 Nonrepeatability—% ± 0.05

TEMPERATURE

Compensated Range—°F ± 75 to ± 175
 Compensated Range—°C $+24$ to $+80$
 Operating Range—°F -65 to $+225$
 Operating Range—°C -54 to $+107$
 Effect on Output—%/°F-MAX ± 0.002
 Effect on Zero—% RO/°F-MAX ± 0.002

ELECTRICAL

Rated Output—mV/V (Nominal)2.0
 (5350-101.3)
 Bridge Resistance—Ohm (Nominal)350
 Excitation Voltage—MAX10 VDC

MECHANICAL

CalibrationCW & CCW
 Safe Overload—% CAP200

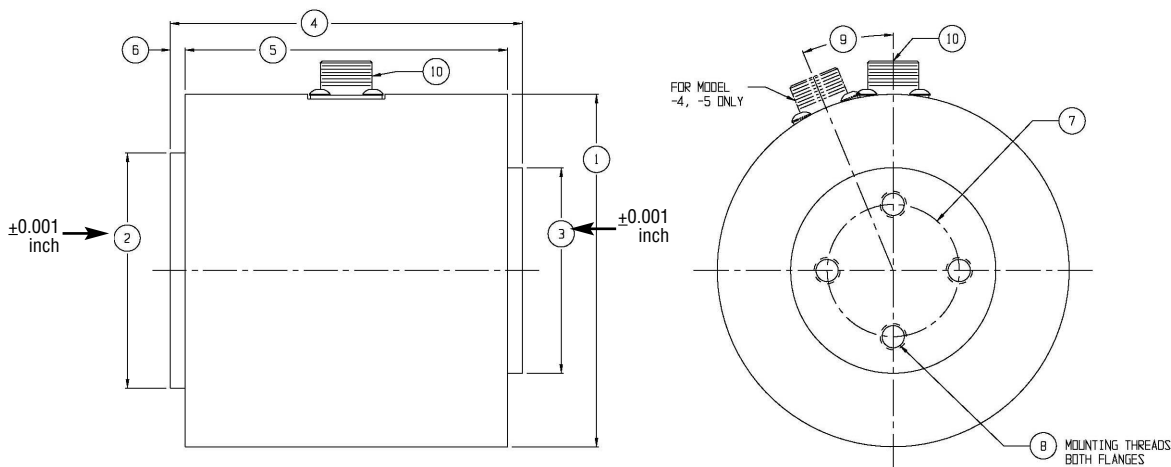

*Model 5350 & 5355

*Amplified Output Available. Please consult factory for details.